



## *Welcome to Colors in Music*

Welcome and thank you for choosing to participate in the Northstars Varsity Winterguard Colors in Music Competition being held on March 25<sup>th</sup>, 2017. Here is some important information we would like to share with you.

Our main doors will open for spectators at 2:00 PM. The gym doors will open at 2:30 PM. Our National Anthem will be performed at 3:30 PM with the first team performing at 3:35.

**Tickets:** Tickets will be available at the door for \$6.00 with discounts for seniors & small children.

**Guard Check In:** Each participating guard will be assigned a homeroom. Because of the computers in the school, an adult guard representative must sign a form as the guard arrives stating the room will be returned to the condition in which it was found and pay for repair or replacement for broken or missing items. A GUARD REPRESENTATIVE MUST ARRIVE WITH THE MEMBERS AND SIGN THE FORM. ROOMS WILL NOT BE ASSIGNED UNTIL THIS HAS BEEN DONE.

Guards should be dropped off at the doors by the Main Entrance of the circle at the circle in front. Your guard members will be stamped here and directed to your room. Props and equipment should follow outdoor signs to their drop-off location **The circuit is using Competition Suite and scores and comments will be sent to you through your phone, computer or other digital device.**

**Please note only instructors and chaperones will be allowed in the guard area.** If you have guard members going home with parents please make arrangements in advance to the parents meet them in the cafeteria. This is a policy of the Cicero - North Syracuse School District and will be strictly enforced.

**Video:** We **will be providing an area for you to video your own team.** If you do not have a camera or have some other issue please let us know BEFORE March 18<sup>th</sup> to see if we can help. We will do our best if possible to assist you.

**Pre-Performance Announcements:** All announcements should be typed and clearly labeled with your guard name and the time of your performance. Announcements should be turned in immediately upon check in. Please clarify wording with announcer when you do a sound check. You may also email announcements to [LarSchmidt@Yahoo.Com](mailto:LarSchmidt@Yahoo.Com).

**Sound Checks:** Sound checks will be allowed from 2:30 PM until 3:25 PM and again during intermission only.

**Bus Parking:** Once your guard has been dropped off at the guard check in area, your buses will be instructed by our security staff on where to go to unload props and park. We are asking all buses and equipment vehicles to park in the side lot, as there will be no parking on the circle during the show. Buses will be allowed in to pick up your guard after the show.

**Equipment:** All equipment MUST be carefully padded with special attention to all sabers. All equipment will be inspected before entering the gym.

**No props will be checked in before 1:30 PM.**

**Floors:** The guards will be entering the gym from the left side of judges. And they will exit the gym using the doors on the right. Both of these doors are located near the back of the performance floor. When you are folding your floor mat, you will drop it along the left side and pull across to the right.

**Cafeteria:** The cafeteria will be open as of 2:30 PM with a variety of choices available.

**Seating:** Guard members, chaperones, and your floor crew will be stamped upon arrival. The Mid-York circuit allows a total of 15 staff, chaperones and floor crew combined per unit. Floor crew will be stamped at the prop entrance. These members will be allowed to view the show from **the back side of the gym** only. Since there will be limited seating for the paying public, please remind your members to sit on the back side of the gym. They will be asked to move if they are sitting on the front side.

**Guides:** Your group will be escorted as it makes its way from your classroom to body warm up area. And then you will be instructed to proceed down the hall to the equipment warm up area. It's the director's responsibility to follow the time schedule.

**Warm Ups:** There will be a 7-9 minute body warm up and an 7-9 minute equipment warm up period prior to your performance time. **While we will provide guides, it is the responsibility of the director to make sure their guard arrives for warm ups on time.** As you will notice the equipment warm up area is adjacent to the prop set-up area so please be as quiet and respectful as possible when unloading and loading props.

**Retreat:** Captains only please. Retreat will be held immediately after the final exhibition and senior recognition. Please have your captain's report to the equipment warm up gym after CNS Dance Ensemble performance.

**Comments & sheets:** Please remember to pick up your music CD from the announcers table in the gym. Remember, comments are digital and will be received through competition suite along with the scores. Recaps will be available at the Post Contest meeting.

**Awards:** All groups from each division will be receiving an award.

The **Post Contest Meetings** will be held in the Large Instruction Room (LGI is located across from the cafeteria) and will begin "Northstars Indoor" (the last performance of the evening). There will not be any meetings during intermission. Directors are asked to wait in the south dining area (body warm-up). This will free up the hallway as guards are leaving and parents are cleaning up.

**Smoking:** There is **No Smoking Permitted** on school grounds. Please remind your parents, chaperones and floor crew of this important rule.

**Directions :**

**From the North**~ Take Route 81 South, exit 28 Taft Road. Turn right onto Taft Rd/ School will be on your right approx 1 mile. You will go thru 3 lights, school is at the fourth light.

**From the South** ~ Take Route 81 North, exit 28 Taft Road. Turn left onto Taft Rd. School will be on your right approx. 1 mile. You will go thru 3 lights, school is at the fourth light.

**From the West** ~(Rochester) **Or East** (Albany) Take NYS Thruway to exit 36, straight after toll booths to Route 81 North. Take exit 28 Taft Road. Turn left onto Taft Rd. School will be on your right approx 1 mile. You will go thru 3 lights, school is at the fourth light.

If using a GPS the address is:

**North Syracuse Junior High School**  
**5353 W. Taft Road**  
**North Syracuse, NY 13212**

If you need to contact us the day of the show, we can be reached at the following numbers.

Larry Schmidt 315-402-7318  
Danette Colburn (315) 727-1083

Good Luck to All and Enjoy the Show!

Sincerely;

Larry Schmidt, Director CNS JV Guard  
Karen Seamans, Director CNS Jr Guard

Danette Colburn  
Home Show Coordinator

# Show Colors in Music

Date 3/25/2017

#	Guard	Class	Ready	Travel from	Travel to	Body Warm-up start	Body Warm-up end	Travel from	Travel to	EQ Warm-up start	EQ Warm-up end	Travel from	Travel to	Perform Start	Perform End
1	CNS Dance Ensemble		3:03	3:03	3:09	3:09	3:16	3:16	3:22	3:22	3:29	3:29	3:35	3:35	3:42
2	Phoenix ERA	ERA	3:11	3:11	3:16	3:16	3:24	3:24	3:29	3:29	3:37	3:37	3:42	3:42	3:50
3	Marcus Whitman Cadet	Cadet	3:19	3:19	3:24	3:24	3:32	3:32	3:37	3:37	3:45	3:45	3:50	3:50	3:58
4	Central Square Cadet	Cadet	3:27	3:27	3:32	3:32	3:40	3:40	3:45	3:45	3:53	3:53	3:58	3:58	4:06
5	Pine Grove	Cadet	3:35	3:35	3:40	3:40	3:48	3:48	3:53	3:53	4:01	4:01	4:06	4:06	4:14
6	Victor Cadet	Cadet	3:43	3:43	3:48	3:48	3:56	3:56	4:01	4:01	4:09	4:09	4:14	4:14	4:22
7	Baldwinsville Cadet	Cadet	3:51	3:51	3:56	3:56	4:04	4:04	4:09	4:09	4:17	4:17	4:22	4:22	4:30
8	Liverpool Cadet	Cadet	3:59	3:59	4:04	4:04	4:12	4:12	4:17	4:17	4:25	4:25	4:30	4:30	4:38
	Judges Break													4:38	4:43
9	Liverpool JV	SRA	4:12	4:12	4:17	4:17	4:25	4:25	4:30	4:30	4:38	4:38	4:43	4:43	4:51
10	CNS SRA	SRA	4:20	4:20	4:25	4:25	4:33	4:33	4:38	4:38	4:46	4:46	4:51	4:51	4:59
11	Baldwinsville JV	SRA	4:28	4:28	4:33	4:33	4:41	4:41	4:46	4:46	4:54	4:54	4:59	4:59	5:07
12	Patriots Too	IRA	4:36	4:36	4:41	4:41	4:49	4:49	4:54	4:54	5:02	5:02	5:07	5:07	5:15
<b>Intermission</b>															
13	Phoenix SA3	SA3	5:14	5:14	5:19	5:19	5:27	5:27	5:32	5:32	5:40	5:40	5:45	5:45	5:53
14	Oxford	SA3	5:22	5:22	5:27	5:27	5:35	5:35	5:40	5:40	5:48	5:48	5:53	5:53	6:01
15	Sherburne-Earville	SA3	5:30	5:30	5:35	5:35	5:43	5:43	5:48	5:48	5:56	5:56	6:01	6:01	6:09
16	Central Square SA3	SA3	5:38	5:38	5:43	5:43	5:51	5:51	5:56	5:56	6:04	6:04	6:09	6:09	6:17
17	CNS JV	SA2	5:46	5:46	5:51	5:51	5:59	5:59	6:04	6:04	6:12	6:12	6:17	6:17	6:25
18	ESM	SA2	5:54	5:54	5:59	5:59	6:07	6:07	6:12	6:12	6:20	6:20	6:25	6:25	6:33
19	New Hartford	SA2	6:02	6:02	6:07	6:07	6:15	6:15	6:20	6:20	6:28	6:28	6:33	6:33	6:41
20	Central Square SA1	SA1	6:10	6:10	6:15	6:15	6:23	6:23	6:28	6:28	6:36	6:36	6:41	6:41	6:49
21	Liverpool Varsity	SA1	6:18	6:18	6:23	6:23	6:31	6:31	6:36	6:36	6:44	6:44	6:49	6:49	6:57
22	Baldwinsville Varsity	SA1	6:26	6:26	6:31	6:31	6:39	6:39	6:44	6:44	6:52	6:52	6:57	6:57	7:05
23	Patriots	IA	6:55	6:55	6:55	6:55	7:00	7:00	7:00	7:00	7:05	7:05	7:05	7:05	7:10
	Judges Break													7:10	7:15
24	Phoenix Sr	SO	6:45	6:45	6:49	6:49	6:58	6:58	7:02	7:02	7:11	7:11	7:15	7:15	7:24
25	Victor Varsity	SO	6:54	6:54	6:58	6:58	7:07	7:07	7:11	7:11	7:20	7:20	7:24	7:24	7:33
26	CNS Varsity	SO	7:03	7:03	7:07	7:07	7:16	7:16	7:20	7:20	7:29	7:29	7:33	7:33	7:42
27	Brigadiers	IO	7:12	7:12	7:16	7:16	7:25	7:25	7:29	7:29	7:38	7:38	7:42	7:42	7:51
28	CNS Drumline	Exh	7:20	7:20	7:25	7:25	7:33	7:33	7:38	7:38	7:46	7:46	7:51	7:51	7:59
	<b>Awards</b>	<b>Captains line up in equipment warm-up gym at 7:46</b>												<b>7:59</b>	<b>8:29</b>

# The CNS Winter Guard Colors in Motion/Music Winterguard Show

## Homeroom Agreement

Date: \_\_\_\_\_

Guard Name: \_\_\_\_\_

Name: \_\_\_\_\_

(please print)

As the representative for the above named unit, I agree to return the homeroom to which we have been assigned to the condition in which it was found. Further, I understand that any electronic devices that may be in the room (i.e. computer, TV) are not to be used.

I also understand that the unit's Director and/or the Director's organization will be held responsible for any damages or missing items.

Do not open or go through the teacher's desk or any closed files.

Homeroom Assigned: \_\_\_\_\_

Signature: \_\_\_\_\_

Title: \_\_\_\_\_

# FLOOR CREW / STAFF / CHAPERONE SIGN IN SHEET

GUARD \_\_\_\_\_ Class \_\_\_\_\_

1. \_\_\_\_\_

2. \_\_\_\_\_

3. \_\_\_\_\_

4. \_\_\_\_\_

5. \_\_\_\_\_

6. \_\_\_\_\_

7. \_\_\_\_\_

8. \_\_\_\_\_

9. \_\_\_\_\_

10. \_\_\_\_\_

11. \_\_\_\_\_

12. \_\_\_\_\_

13. \_\_\_\_\_

14. \_\_\_\_\_

15. \_\_\_\_\_

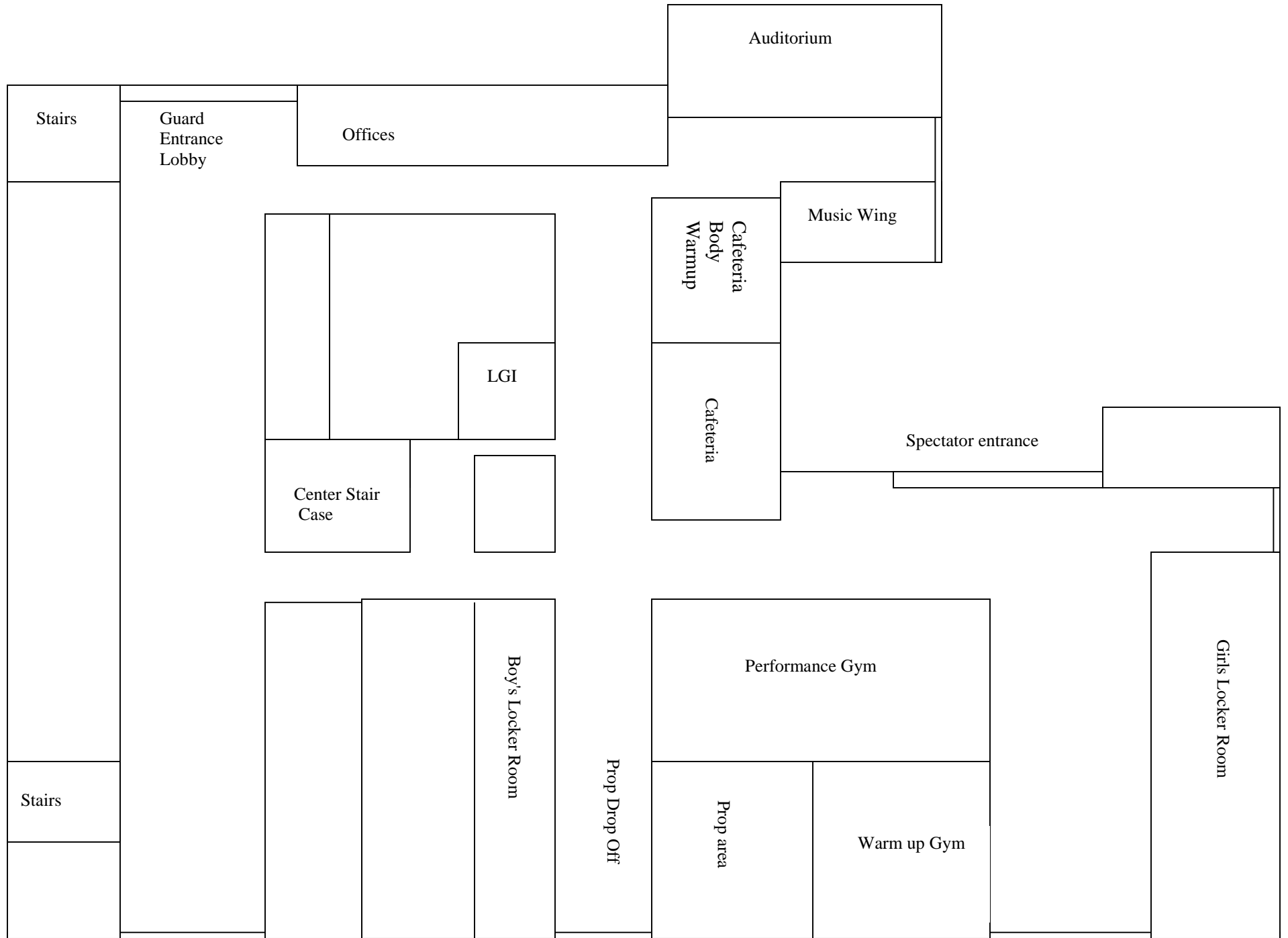

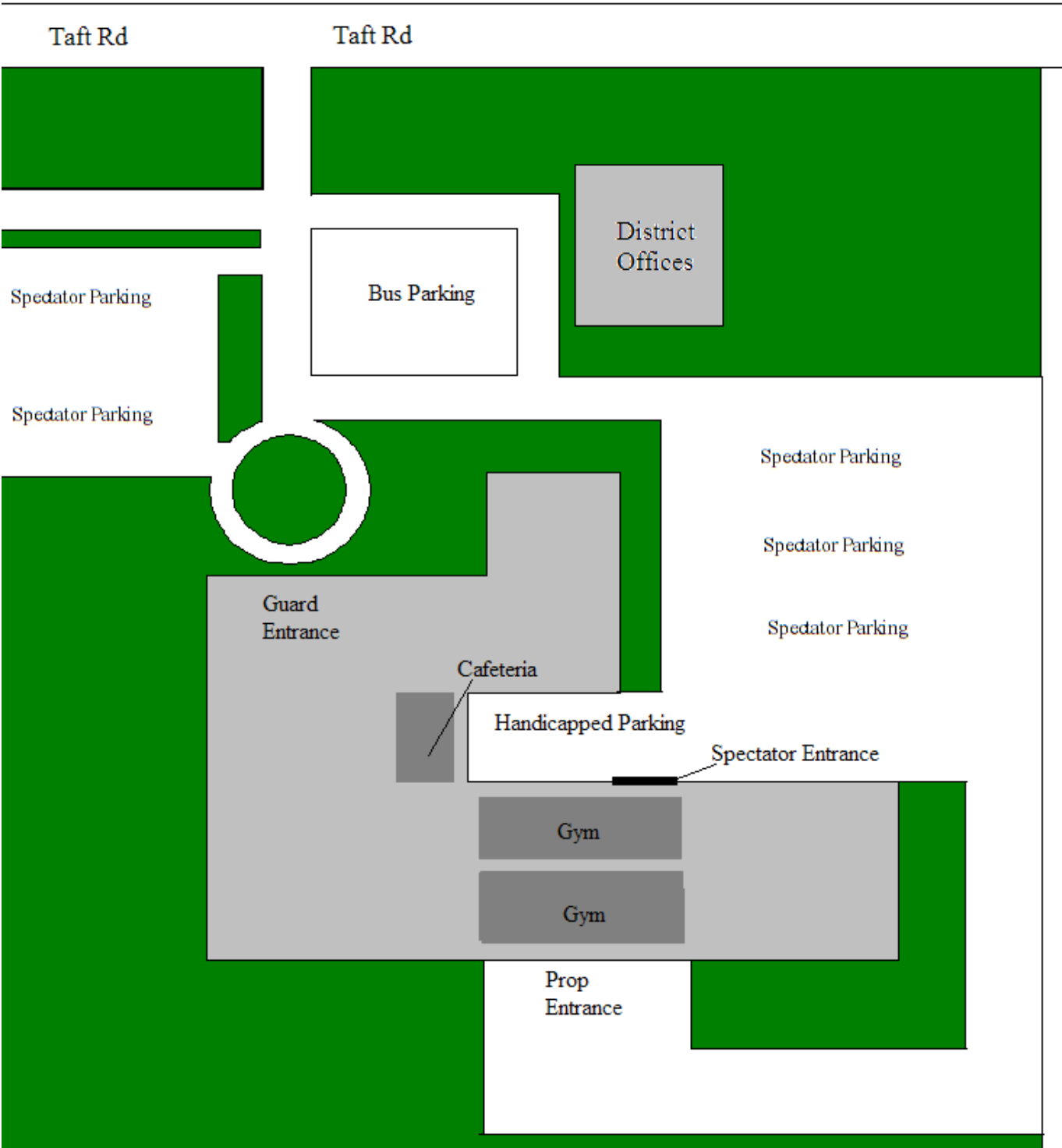



## Post Contest Critique Order

### Round 1

Victor Cadet

Marcus Whitman Cadet

Patriots Too

Oxford

Sherburne-Earlville

### Round 2

Phoenix ERA

Central Square Cadet

Pine Grove

Baldwinsville Cadet

Liverpool Cadet

### Round 3

New Hartford

Patriots

Victor Varsity

Baldwinsville JV

Liverpool JV

### Round 4

Phoenix SA3

Central Square SA3

ESM

Central Square SA1

Baldwinsville Varsity

### Round 5

Liverpool Varsity

Phoenix Sr

Brigadiers

CNS SRA

CNS JV

### Round 6

CNS Varsity